

Pavilion II LED

Project Name:

Catalog Number:

Type



Dimensional Drawings

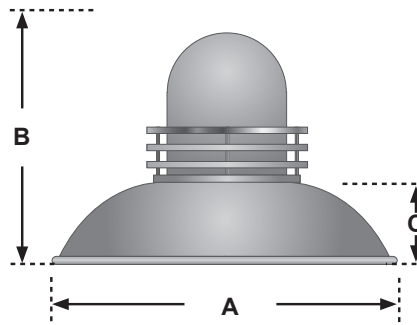

Fixture	A	B	C	Max. LEDs	Lbs
PD-L	26"	18"	8"	84	30

The **Pavilion II LED** series is a versatile and contemporary fixture ideal for architectural applications where scale and style are essential.

Two cap choices combined with three shapes of shades; allow for a number of design options. Type I, II, III IV, V and V-W LED optics are available and are Dark-Sky approved. The decorative rings are 3/8" cast aluminum.

Durable polyester powder coat finish is available in an array of architectural colors.

The **Pavilion II** series is an elegant choice for parks, retail settings, restaurants, marinas and sports arenas.

Cap w/ Aluminum Rings (C1)

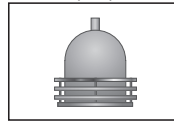

Cap w/out Rings (C3)

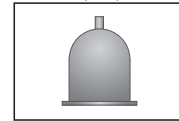

Curved-Out Shades (H1)

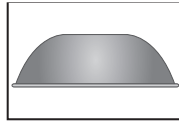

Straight Shades (H2)

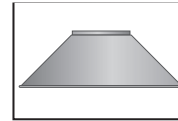

Curved-In Shades (H3)

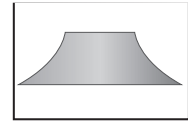

Model	Optics	Source	Milliamps	Kelvin	Voltage	Mounting	Finish	Cap/Shade	Options				
PD-L	Type I (T1)	# of LEDs 42 (42LC)	350 (3)	4000K *Neutral white (4K)	120-277 *Universal voltage (UNV)	Arm Mount (AM)	Bronze (BZ)	Cap C1 (C1)	Button Type Photocell *Specify voltage (PC120) (PC208) (PC240) (PC277) Fusing *Specify voltage Single in-line fuse (SF120) (SF277) Double in-line fuse (DF208) (DF240) Cutoff Louver System (CLS) High-Low System (HL) 0-10 V Dimming Driver *No controls (DIM) 10KV Surge Protector (10KV)				
	Type II (T2)					84 (84LC)	530 (5)	5500K *Cool white (55K)		480 (5)	Yoke Mount 1 Bar (YM1)	Black (BK)	Cap C3 (C3)
	Type III (T3)									347 (8)	Yoke Mount 2 Bars (YM2)	White (WH)	Shade H1 (H1)
	Type IV (T4)										Wall Mount *Requires decorative arm (WM)	Forest Green (FG)	Shade H2 (H2)
	Type V (T5)											Grey (GY)	Shade H3 (H3)
	Type VW (T5W)											Silver Metallic (SL)	
	Type VW (T5W)						Custom Color (CC)						

For more detailed information on mounting, wiring or installation instructions, please consult factory. If poles are not ordered with fixtures, please specify mounting requirements. This document contains proprietary information of Visionaire Lighting LLC. Any use of this information requires the written approval of Visionaire Lighting, LLC. In keeping with our TQM policy of continuous improvement, Visionaire reserves the right to change any specifications contained herein without prior notice.

ARCHITECTURAL

Housing

- The driver housing and reflector shade are constructed from two-piece, heavy-gauge, spun aluminum with a rolled edge for added strength. Choose straight, curved-out or curved-in shades.
- All external hardware is stainless steel.
- Decorative rings are 3/8" cast aluminum.

Door Assembly

- A cast aluminum tool-less door allows easy access into housing and is fully gasketed with a form-fitting one-piece premium extruded silicone gasket to provide complete weather and insect protection.

Optical System

- The highest lumen output **Evo/C LEDs** are utilized. Estimated life of the LEDs is a minimum of 100,000 hours. IES distribution types I, II, III, IV, V and V-W are standard. Available with up to 84 LEDs. The optical system qualifies as IES full cutoff; and is Dark-Sky certified to restrict light trespass, glare and light pollution for neighborhood-friendly lighting.
- CRI values are 70 for 4000K and 75 for 5500K.

Quali-Guard® Finish

- Aluminum fixture components are chemically pretreated through a multiple-stage washer and finished with an electrostatically-applied, thermoset polyester powder coat textured paint with a minimum of 3 to 5 mils thickness. Finish is oven-baked at a temperature of 400 °F to promote maximum adherence and finish hardness. All finishes are available in standard and custom colors.

Mounting

- **Pavilion II** mounts to a wide selection of decorative and custom mounting arms for both pole and wall mount applications (see Decorative Arms section of catalog).

Electrical Assembly

- The **Pavilion II** is supplied with a high-performance LED driver, located in its cap, that accepts 120 V through 277 V, 50 Hz to 60 Hz input. Power factor is 90%. Rated for -40 °F operation.
- High-low system offers motion control or factory preset switching options. Consult factory for specific details.
- 3 kV surge protector supplied as standard.

Warranty

- Five (5) year Limited Warranty on entire system, including finish. For full warranty information, please visit VisionaireLighting.com.

Solar Panel Option

- The **Pavilion II** is compatible for use with Visionaire Lighting's Solar Panel Pole™.

Options

- Button type photocell
- Fusing
- Cutoff louver system
- High-low system
- 0-10 V dimming driver
- 10KV Surge Protector

Listings

- Pavilion II is ETL listed, suitable for wet locations.
- Dark-Sky Friendly® full cutoff certified by the International Dark-Sky Association.
- LM79.
- LM80.
- Powder Coated Tough™ 
- RoHS compliant.

Cap and Shade Combinations

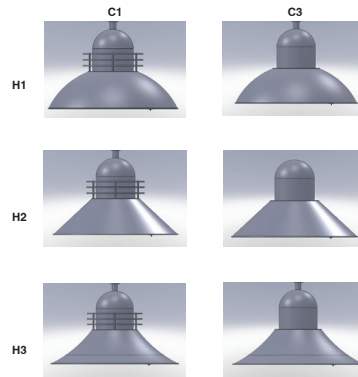

Mounting Detail

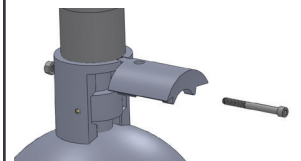

LED Data Chart for 5500K*

# LEDs	Output mA	Type 1	Type 2	Type 3	Type 4	Type 5	Type 5W	Nominal Watts	System Watts
42	350	3933	4076	3848	4126	4189	4795	45	120
	530	4760	5256	5032	5809	5538	6251	66	46
84	350	7818	8151	7592	10444	8243	8302	90	70
	530	9520	10513	10064	11964	11206	11809	132	92

Visit www.VisionaireLighting.com for up-to-the-minute chart information, including types not listed here.

* For 4000K multiply values by 0.90

Typical Decorative Arms - (Additional Arms in Mounting Arm Section)

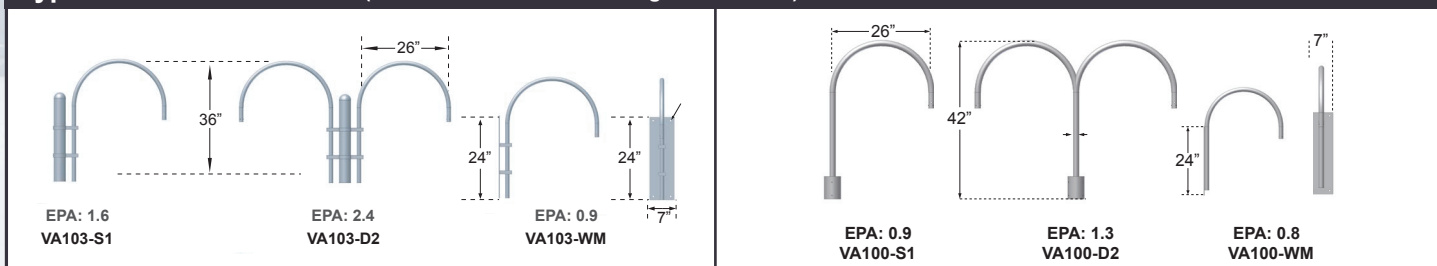

EPA Data

Fixture	Fixture Only	Fixture with VA103-S1	2 Fixtures with VA103-D2	Fixture with VA100-S1	2 Fixtures with VA100-D2
PD-L	2.8	4.4	8.0	3.7	6.9

19645 Rancho Way Rancho Dominguez, CA 90220
Tel: (310) 512-6480 Fax: (310) 512-6486
www.visionairelighting.com